

# LET'S GET YOU SET UP

Quick Start Guide  
Model No. FC100

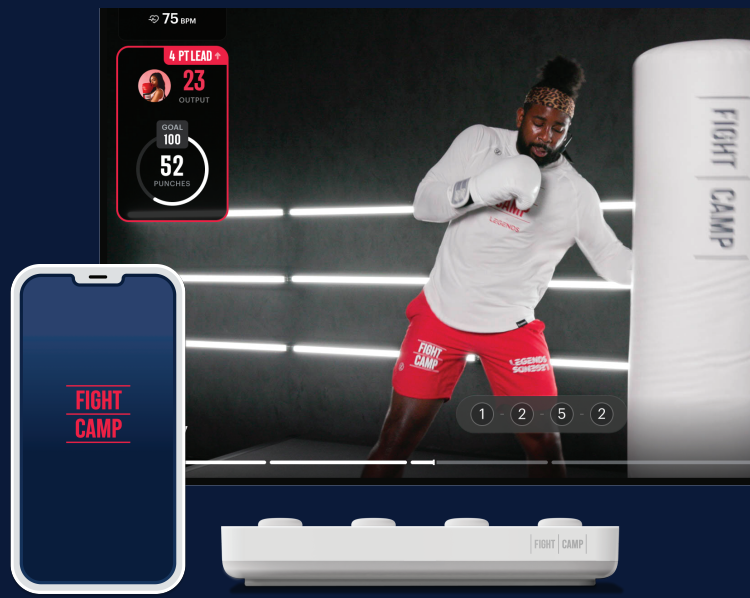

## What's in the Box

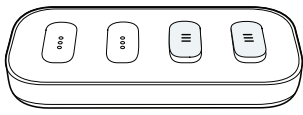

Console & 2 Trackers

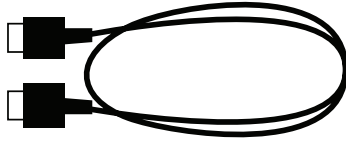

HDMI Cable



USB Charging Cable



Mounting Hardware



Power Adapter

## What You Need



High-speed Internet



Wireless Router or Ethernet



Mobile Device



TV with HDMI Port  
(Recommended)

## HOW TO SET UP THE CONSOLE

Estimated Setup Time: 5 min.

- 1** Flip the console over.

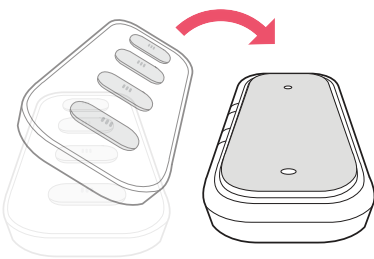

- 2** Lift the bottom panel up to access cable ports.

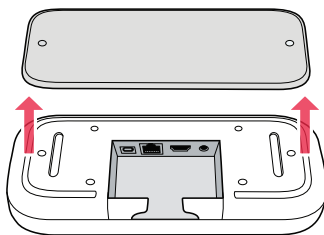

- 3** Plug the cables into the ports.

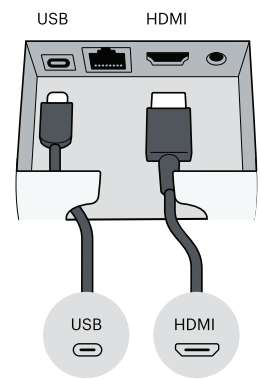

- 4** Re-attach the bottom panel and flip the console over.

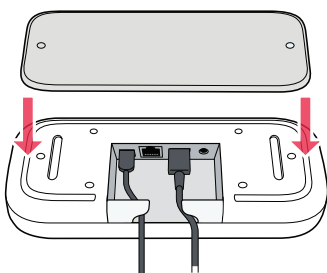

- 5** Connect the console to power supply and TV.

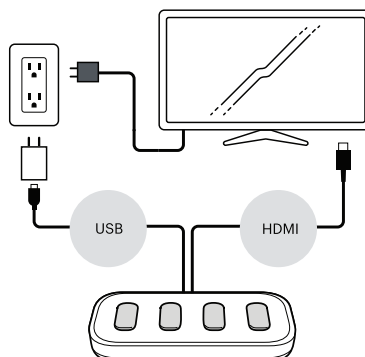

- 6** Turn on your TV and scan the QR code to download or open the FightCamp app.

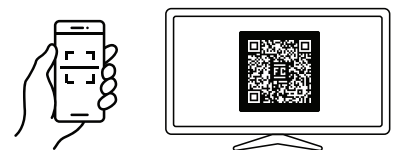

Follow the instructions in the app to finish setup.



If you're not using Console with a TV, scan this QR Code to download the app & continue setup.

# HOW TO MOUNT THE FIGHTCAMP CONSOLE

Wall Mount Instructions  
(Optional)

## What You Need



Anchors (included)



Screws (included)

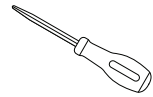

Screwdriver

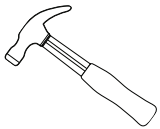

Hammer

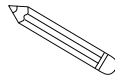

Pencil



Drill with  
3/16" drill bit

- 1** Using the bottom panel as a guide, mark the two holes.

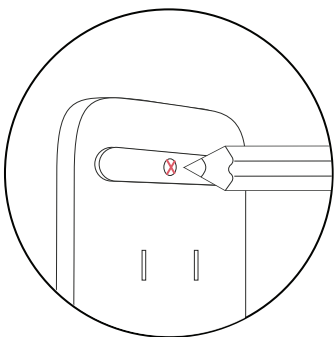

- 2** Drill two holes in the wall using a 3/16" drill bit.

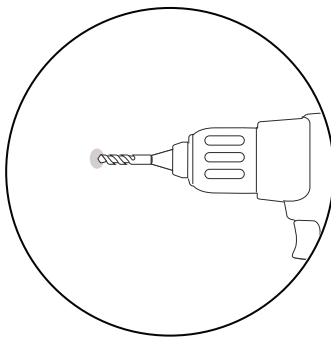

- 3** Gently tap in the anchors with a hammer.

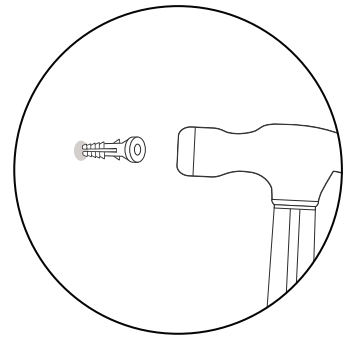

- 4** Align bottom panel holes with the anchor holes.

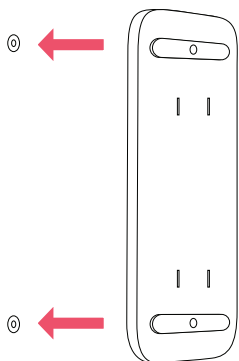

- 5** Insert the screws and slowly screw them in.

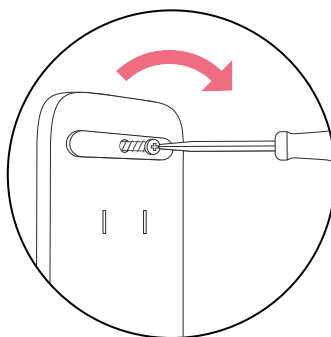

- 6** Attach the console to the bottom panel. Done!

